

CONSTRUCTION DETAIL				CONSTRUCTION DETAIL (CONTINUED)			
Element	Cd.	Ch.	Description	Element	Cd.	Ch.	Description
Style	45		Apt House				
Model	01		Residential				
Grade	03		Average				
Stories	2						
Occupancy	4						
Exterior Wall 1	07		Asbest Shingle				
Exterior Wall 2							
Roof Structure	03		Gable/Hip				
Roof Cover	03		Asph/F Gls/Cmp				
Interior Wall 1	03		Plastered				
Interior Wall 2							
Interior Flr 1	12		Hardwood				
Interior Flr 2							
Heat Fuel	02		Oil				
Heat Type	05		Hot Water				
AC Type	01		None				
Total Bedrooms	04		4 Bedrooms				
Total Bthrms	3						
Total Half Baths							
Total Xtra Fixtrs							
Total Rooms	9						
Bath Style	03		Modern				
Kitchen Style	03		Modern				
				MIXED USE			
				Code	Description	Percentage	
				1114	4 FAMILY MDL-01	100	
				COST/MARKET VALUATION			
				Adj. Base Rate:	178.71		
				Section. RCN:	365,105		
				Net Other Adj:	0.00		
				Replace Cost	365,105		
				AYB	1910		
				EYB	1976		
				Dep Code			
				Remodel Rating	04		
				Year Remodeled	2003		
				Dep %	30		
				Functional Obslnc			
				External Obslnc			
				Cost Trend Factor	1		
				Condition			
				% Complete			
				Overall % Cond	70		
				Apprais Val	255,600		
				Dep % Ovr	0		
				Dep Ovr Comment			
				Misc Imp Ovr	0		
				Misc Imp Ovr Comment			
				Cost to Cure Ovr	0		
				Cost to Cure Ovr Comment			

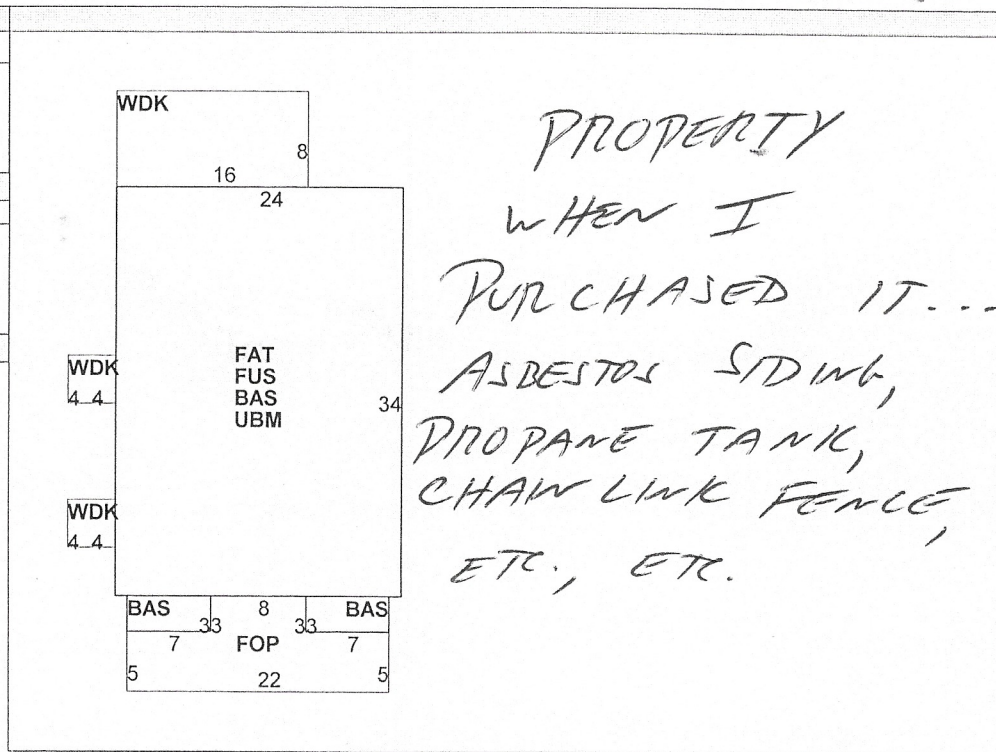

OB-OUTBUILDING & YARD ITEMS(L) / XF-BUILDING EXTRA FEATURES(B)												
Code	Description	Sub	Sub Descript	L/B	Units	Unit Price	Yr	Gde	Dp Rt	Cnd	%Cnd	Apr Value
FGR	GARAGE-POC			L	780	13.00	1930		0		30	3,000

BUILDING SUB-AREA SUMMARY SECTION						
Code	Description	Living Area	Gross Area	Eff. Area	Unit Cost	Undreprec. Value
BAS	First Floor	858	858		178.71	153,333
FAT	Attic, Finished	163	816		35.70	29,130
FOP	Porch, Open, Finished	0	134		36.01	4,825
FUS	Upper Story, Finished	816	816		178.71	145,827
UBM	Basement, Unfinished	0	816		35.70	29,130
WDK	Deck, Wood	0	160		17.87	2,859
Ttl. Gross Liv/Lease Area:		1,837	3,600			365,105





PREVIOUS
OWNER
RENTED
OUT PARKING
SPACE @
BOX TRUCK

High St

Gould St

Oak Dell St

GIS Map

Town of South Kingstown
Washington County, Rhode Island



The Town of South Kingstown makes no warranty as to the accuracy, reliability, completeness of the information and is not responsible for any errors or omissions or for results obtained from the use of the information.

Scale 1:480
1 Inch = 40 Feet

Parcel Boundaries as of July 2009

Not legally binding for title or zoning purposes

Horizontal Datum is Rhode Island State Plane Feet, NAD83

