

Z:\DEMAIN\PROJECTS\0267-059 SOUTH COUNTY COMMONS\AUTOCAD DRAWINGS\0267-059-A09-PLAN-B26 & B28.DWG PLOTTED: 4/15/2025

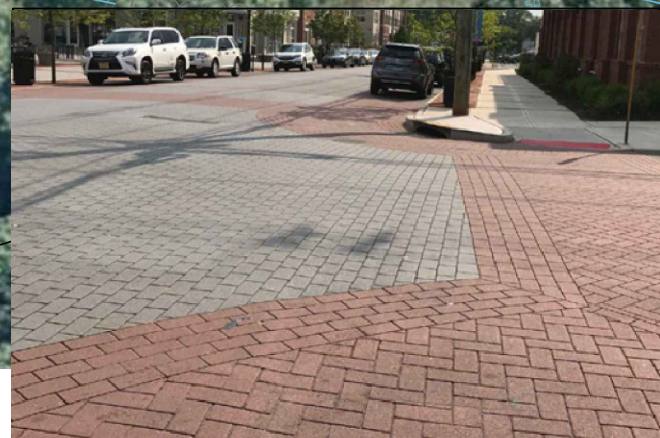

STAMPED COLORED THERMOPLASTIC PAVEMENT TO PROVIDE GREATER AESTHETICS AND INTERSECTION AWARENESS

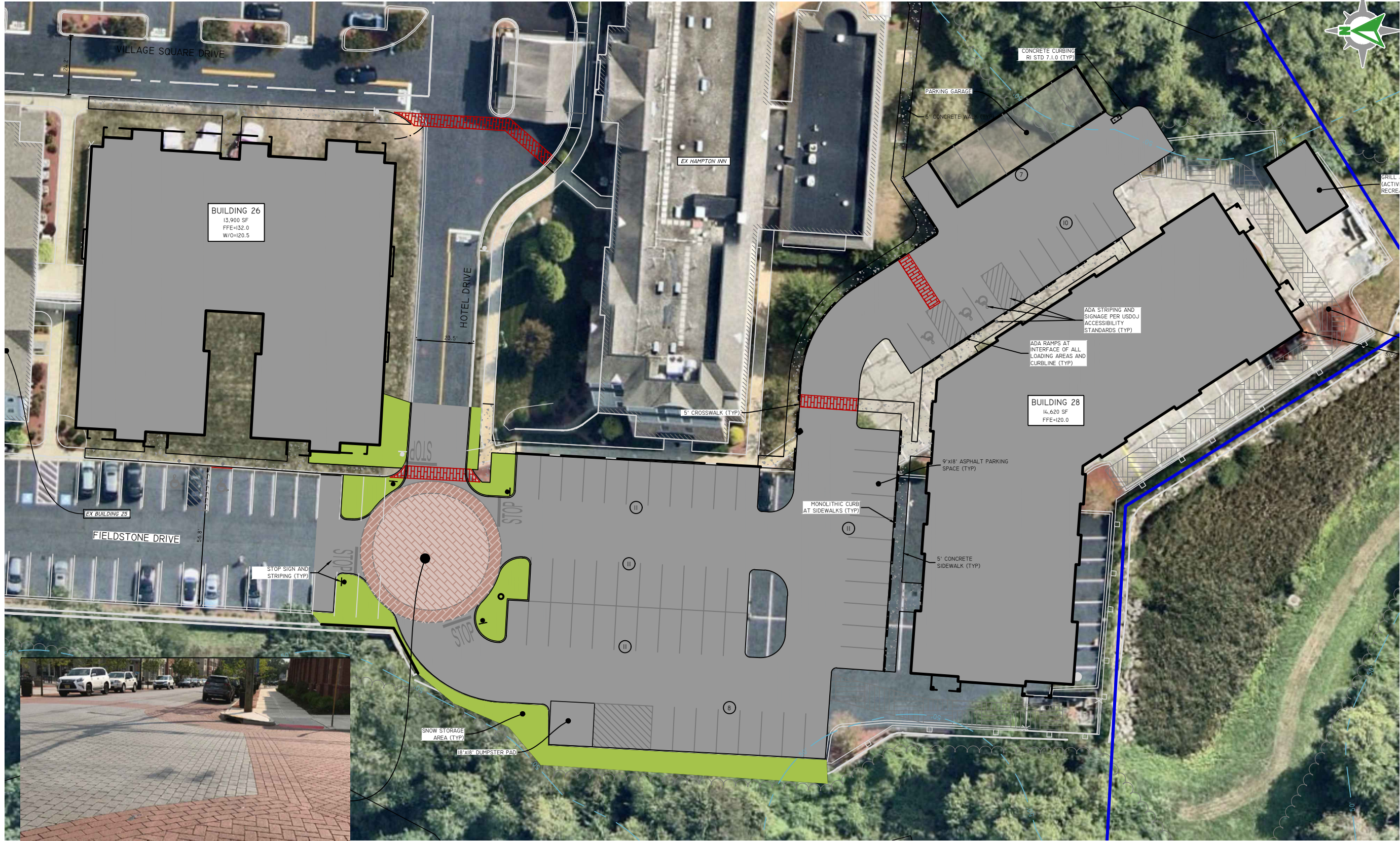
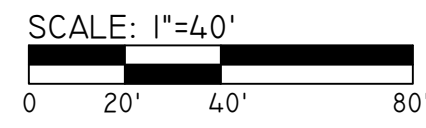

Diprete Engineers
 Engineers • Planners • Surveyors
 www.diprete-eng.com

HOTEL DRIVE/FIELDSTONE DRIVE INTERSECTION EXHIBIT
SCC BUILDINGS 26 & 28
 SOUTH KINGSTOWN, RHODE ISLAND
 PREPARED FOR:
 DATE: 04-10-2025
 DE JOB NO: 0267-059 COPYRIGHT 2025 BY DIPRETE ENGINEERING ASSOCIATES, INC.