



Celebrating 100 years



Helping people since 1922

NEW BRANCH OFFICE

PROPOSED SITE PLAN - REVISED
SOUTH KINGSTOWN, RI

DECEMBER 27th, 2023

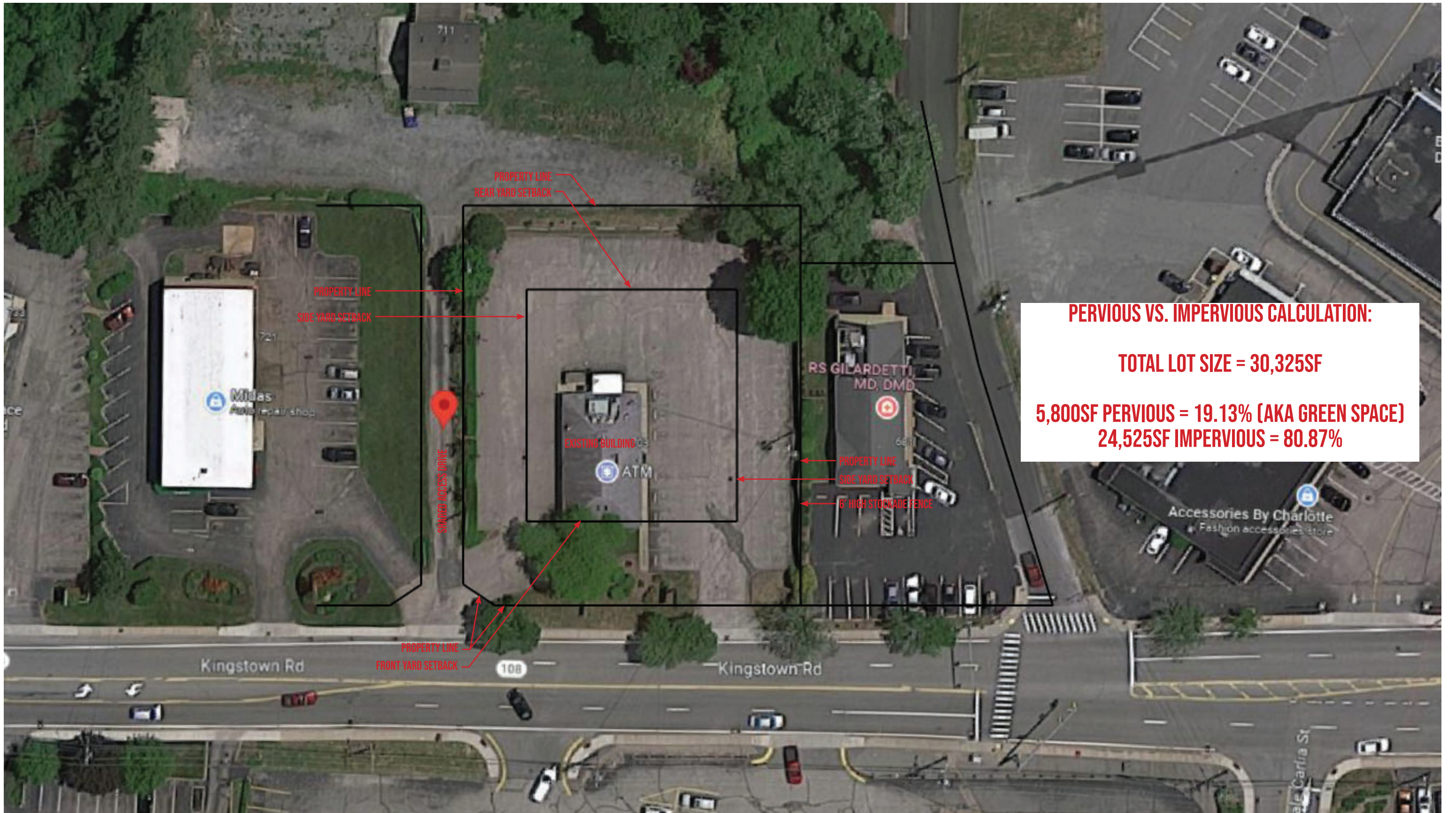

PERVIOUS VS. IMPERVIOUS CALCULATION:

TOTAL LOT SIZE = 30,325SF

5,800SF PERVIOUS = 19.13% (AKA GREEN SPACE)

24,525SF IMPERVIOUS = 80.87%

EXISTING SITE PLAN | DECEMBER 27TH, 2023

Note: All plans, elevations, & renderings are schematic and for illustrative purposes only. Final design is subject to field verification. Final materials and color selections are to be verified during the design development stage. Final construction methods, materials, details, codes & budgets are based on the approved permit construction documents.

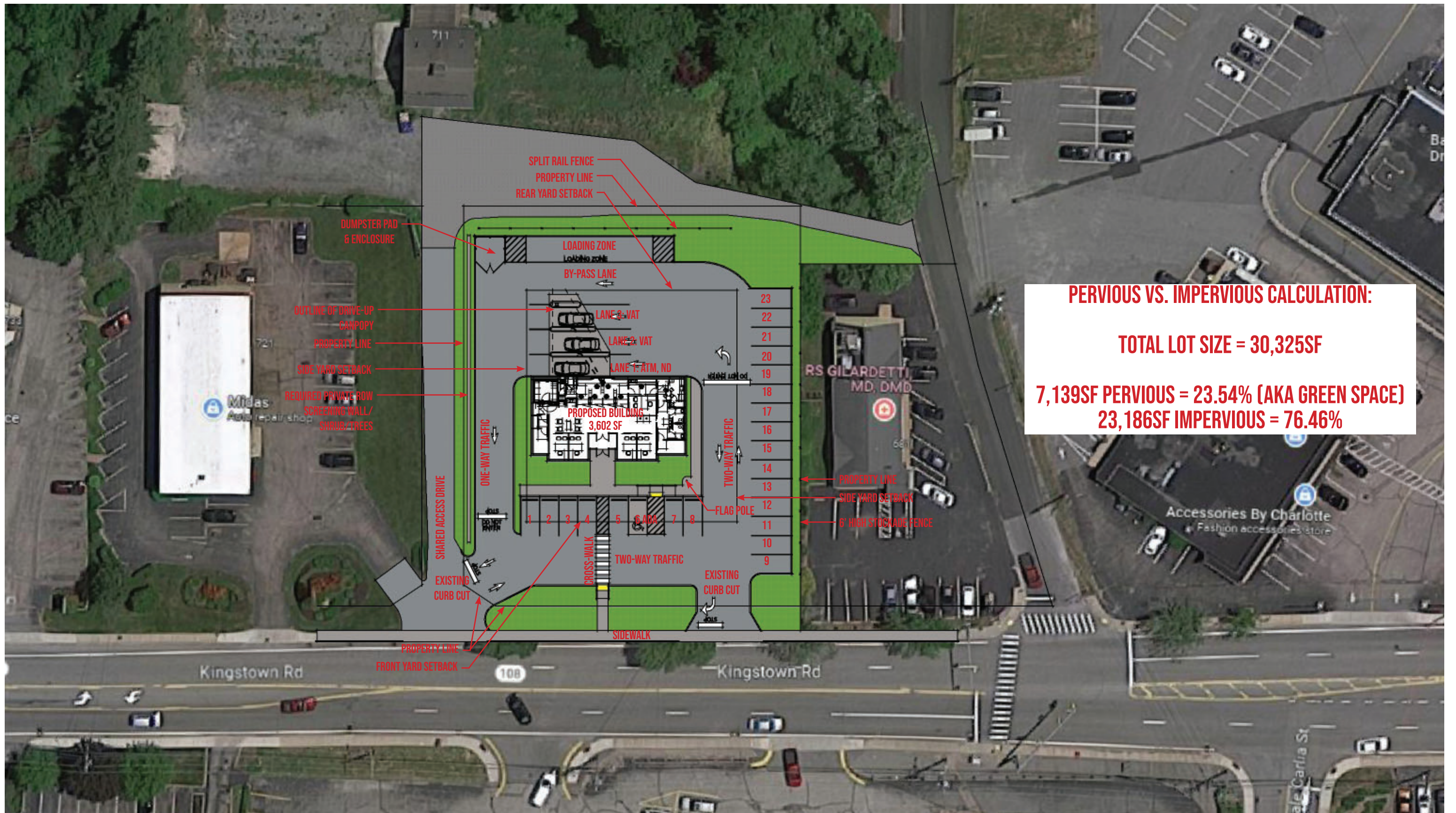

PERVIOUS VS. IMPERVIOUS CALCULATION:

TOTAL LOT SIZE = 30,325SF

7,139SF PERVIOUS = 23.54% (AKA GREEN SPACE)

23,186SF IMPERVIOUS = 76.46%

PROPOSED SITE PLAN - ORIGINAL SUBMISSION | DECEMBER 27TH, 2023

Note: All plans, elevations, & renderings are schematic and for illustrative purposes only. Final design is subject to field verification. Final materials and color selections are to be verified during the design development stage. Final construction methods, materials, details, codes & budgets are based on the approved permit construction documents.

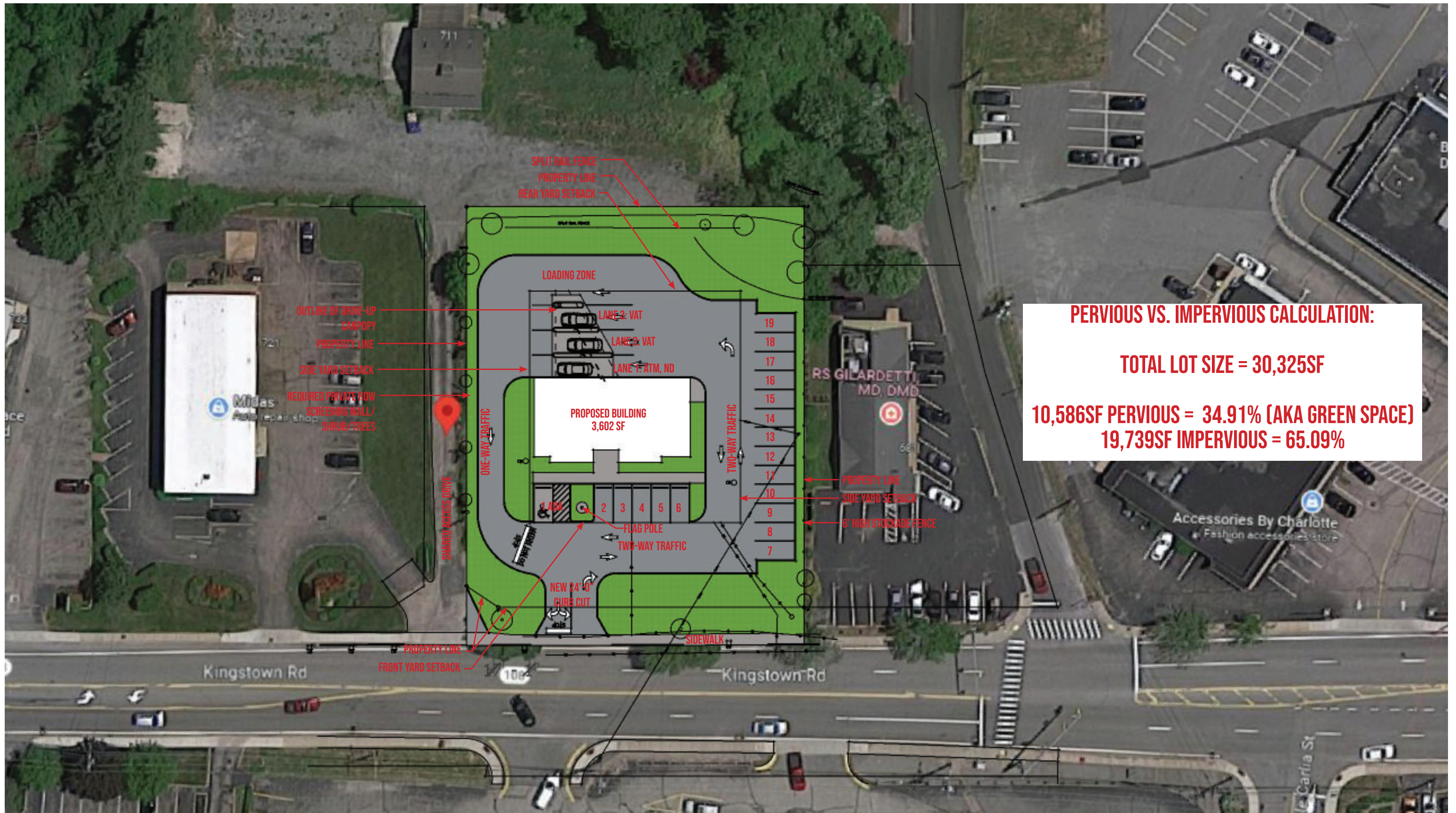

PERVIOUS VS. IMPERVIOUS CALCULATION:

TOTAL LOT SIZE = 30,325SF

10,586SF PERVIOUS = 34.91% (AKA GREEN SPACE)

19,739SF IMPERVIOUS = 65.09%

PROPOSED SITE PLAN - ORIGINAL REVISED | DECEMBER 27TH, 2023

Note: All plans, elevations, & renderings are schematic and for illustrative purposes only. Final design is subject to field verification. Final materials and color selections are to be verified during the design development stage. Final construction methods, materials, details, codes & budgets are based on the approved permit construction documents.

Crispin Conklin, RA|NCARB

Design Architect

📍 109 Zeta Drive | Pittsburgh, PA 15238

☎ 412.967.9696 x432 📱 412.977.2278

🌐 www.pwcampbell.com

Kevin Poirot

Executive Vice President, Branded Environments

a: 1957 Pioneer Road, Bldg A | Huntingdon Valley, PA 19006

p: 412.963.0100 x103 c: 412.736.3517

w: pwcampbell.com

