



STATE OF RHODE ISLAND AND PROVIDENCE PLANTATIONS

Department of Environmental Management

Office of Water Resources

Onsite Wastewater Treatment System Program



AUG 17 2023

Site Evaluation Form

Part A - Soil Profile Description

Application Number 0413-0456

Property Owner: HLLTOP GLOUCESTER (MER-MAC) PREVIOUSLY JOSEPH CAMPANO

Property Location: 660 PUTNAM PIKE GLOUCESTER NEW NAME

Date of Test Hole: 5/19/23

Soil Evaluator: JEFFREY J CAMPANO P.E.

License Number: 4057

Weather: COOL, BRIGHT

Shaded: Yes No Time: 9-10 AM

TH 1 Horizon	Depth	Horizon Boundaries		Soil Colors		Re-Dox		Texture	Structure	Consistence	Soil Category
		Dist	Topo	Matrix	Re-Dox Features	Ab.	S. Contr.				
A	0-Z	-	-	10YR 4/4	-	-	-	1S	8C	FC	4
B _w	2-10	A	S	10YR 5/4	-	-	-	1S	1Sbk	FC	4
C	10-110	C	S	10YR 5/3	-	-	-	cb st CS	5G	FC	1
TH 2 Horizon	Depth	Horizon Boundaries		Soil Colors		Re-Dox		Texture	Structure	Consistence	Soil Category
		Dist	Topo	Matrix	Re-Dox Features	Ab.	S. Contr.				
A	0-Z	-	-	10YR 3/4	-	-	-	1S	9C	FC	4
B _w	2-12	C	S	10YR 5/4	-	-	-	1S	5bk	FC	4
C	12-90	C	S	10YR 5/3	-	-	-	cb st CS	5G	FC	1

TH 1 Soil Class C Total Depth 110 Impervious/Limiting Layer Depth N/A (og) GW Seepage Depth N/A SHWT 7' (og)

TH 2 Soil Class C Total Depth 90 Impervious/Limiting Layer Depth N/A (og) GW Seepage Depth N/A SHWT 7' (og)

Comments:

COMMERCIAL PROPERTY FORMERLY STRIPPED HOLES LIMITED BY CURLAPSE NOT BEDROCK

Part B

Site Evaluation – to be completed by Soil Evaluator or Class II or III Designer

Please use the area below to locate:

1. Test holes and bedrock test holes,
 2. Approximate direction of due north,
 3. Offsets from all test holes to fixed points such as street, utility pole, or other permanent, marked object.*
- *OFFSETS MUST BE SHOWN**

Key:

- Approximate location of test holes
- Approximate location of bedrock test holes
- Estimated gradient and direction of slope
- Approximate direction of due north

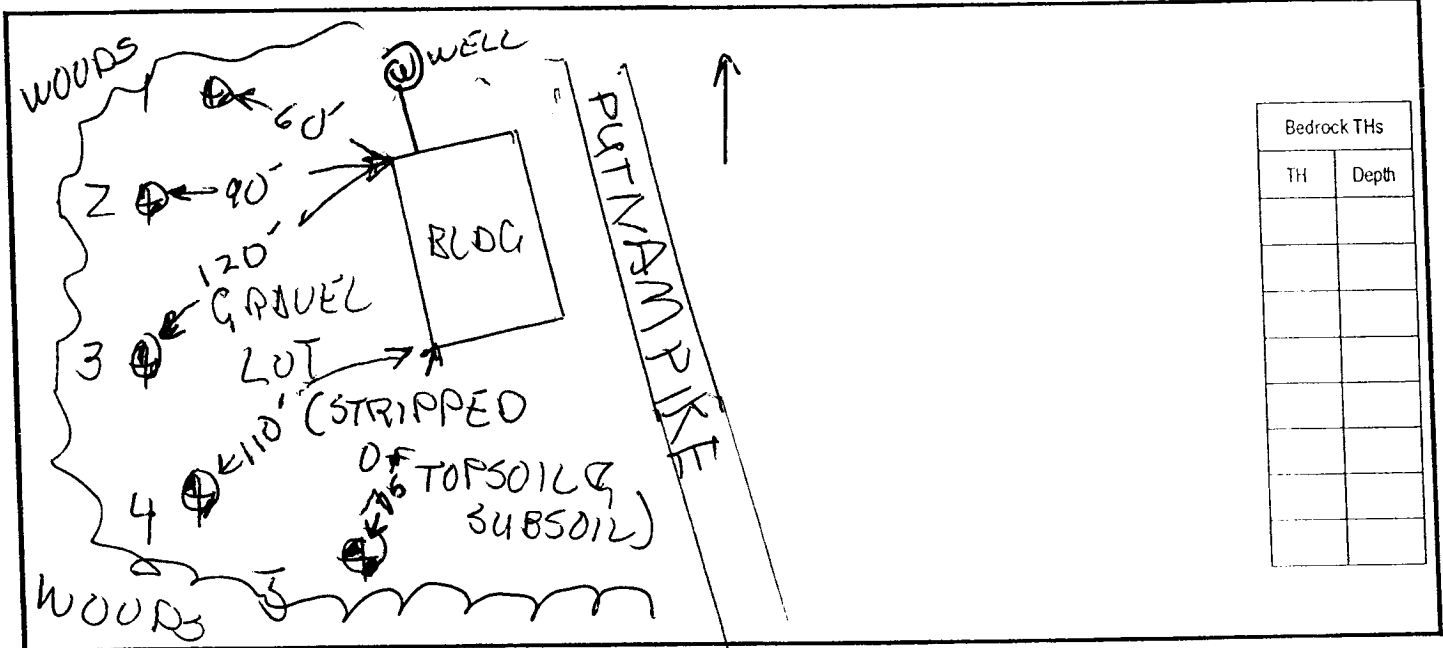

Bedrock THs	
TH	Depth

1. Relief and Slope: 0-2% FLAT
2. Presence of any watercourse, wetlands or surface water bodies, within 200 feet of test holes? If yes, locate on above sketch. NO YES
3. Restrictive Layer or Bedrock within 4' below original ground within 25 feet of test hole? Provide all test hole locations & depths above. NO YES
4. Presence of existing or proposed private drinking water wells within 200 feet of test holes? If yes, locate on above sketch. NO YES
5. Public drinking water wells within 500 feet of test holes? If yes, locate on above sketch. NO YES
6. Is site within the watershed of a public drinking water reservoir or other critical area defined in Rule 38? NO YES
7. Has soil been excavated from or fill deposited on site? If yes, locate on above sketch. NO YES
8. Site's potential for flooding or ponding: NONE SLIGHT MODERATE SEVERE
9. Landscape position: BACKSLOPE
10. Vegetation: WOODS + NONE
11. Indicate approximate location of property lines and roadways.
12. Additional comments, site constraints or additional information regarding site: FOUND OUT WELL LOCATION AFTER DIGGING 1 + 2; OUTWASH SAND; 150' WELL

Certification

The undersigned hereby certifies that all information on this application and accompanying forms, submittals and sketches are true and accurate and that I have been authorized by the owner(s) to conduct these necessary field investigations and submit this request.

Part A prepared by: [Signature] License # 4057 Part B prepared by: [Signature] License # 4057

DO NOT WRITE IN THIS SPACE

Witnessed Soil Evaluation Decision: Concur Inconclusive Disclaim

Unwitnessed Soil Evaluations Decision: Accept Inconclusive Disclaim

Wet Season Determination required Additional Field Review Required

Explanation: _____

[Signature]
Signature Authorized Agent

8/23/23
Date



STATE OF RHODE ISLAND AND PROVIDENCE PLANTATIONS

Department of Environmental Management

Office of Water Resources

AUG 17 2023 Onsite Wastewater Treatment System Program



Site Evaluation Form

Part A - Soil Profile Description

Application Number 0413-0456

Property Owner: HULTOP GLOUCESTER

Property Location: 660 DUTMAN PIKE GLOUCESTER

Date of Test Hole: 5/19/23

Soil Evaluator: JEFFREY J CAMPBELL DE

License Number: 4057

Weather: WARMING, BRIGHT

Shaded: Yes [] No [x] Time: 10 AM

Table with 11 columns: TH Horizon, Depth, Horizon Boundaries (Dist, Topo), Soil Colors (Matrix, Re-Dox Features), Re-Dox (Ab., S., Contr.), Texture, Structure, Consistence, Soil Category. Contains data for TH 3 and TH 4 profiles.

TH 3 Soil Class C Total Depth 104 Impervious/Limiting Layer Depth N/A (og) GW Seepage Depth N/A SHWT 84" (og)

TH 4 Soil Class C Total Depth 96 Impervious/Limiting Layer Depth N/A (og) GW Seepage Depth N/A SHWT 84" (og)

Comments: COMMERCIAL PROPERTY; TOPSOIL STRIPPED & GROUNDS PROVIDED PARKING; COLLAPSING HOLES DEPTH NOT REFUSAL

TH 4 HAD MINOR PEDOGENESIS AT TOP (0/NE) BUT < 1" THICK

Part B

Site Evaluation – to be completed by Soil Evaluator or Class II or III Designer

Please use the area below to locate:

1. Test holes and bedrock test holes,
2. Approximate direction of due north,
3. Offsets from all test holes to fixed points such as street, utility pole, or other permanent, marked object.*
*OFFSETS MUST BE SHOWN

Key:

- Approximate location of test holes
- Approximate location of bedrock test holes
- x% → Estimated gradient and direction of slope
- N ↑ Approximate direction of due north

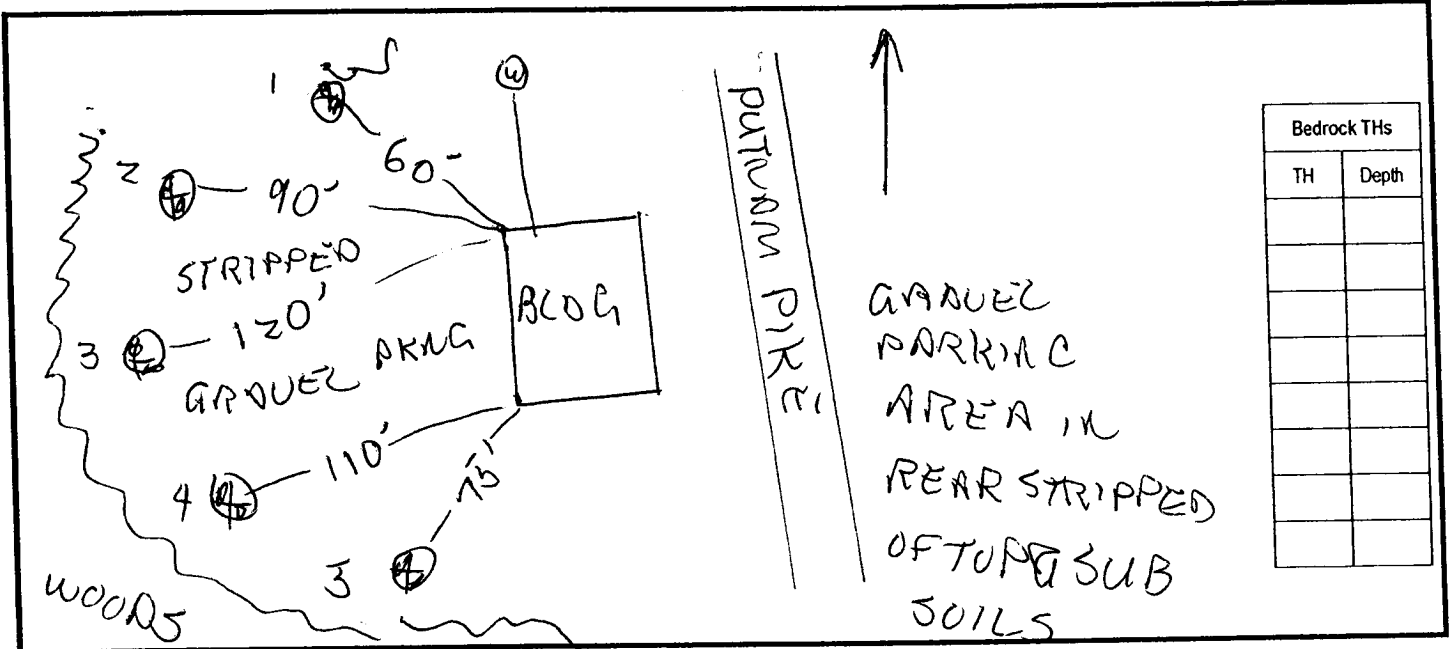

1. Relief and Slope: FLAT 0-2%
2. Presence of any watercourse, wetlands or surface water bodies, within 200 feet of test holes? If yes, locate on above sketch. NO YES
3. Restrictive Layer or Bedrock within 4' below original ground within 25 feet of test hole? Provide all test hole locations & depths above. NO YES
4. Presence of existing or proposed private drinking water wells within 200 feet of test holes? If yes, locate on above sketch. NO YES
5. Public drinking water wells within 500 feet of test holes? If yes, locate on above sketch. NO YES
6. Is site within the watershed of a public drinking water reservoir or other critical area defined in Rule 38? NO YES
7. Has soil been excavated from or fill deposited on site? If yes, locate on above sketch. NO YES
8. Site's potential for flooding or ponding: NONE SLIGHT MODERATE SEVERE
9. Landscape position: BACKSLOPE
10. Vegetation: NONE
11. Indicate approximate location of property lines and roadways.
12. Additional comments, site constraints or additional information regarding site: SOIL 1 ; 150' TOWELL

Certification

The undersigned hereby certifies that all information on this application and accompanying forms, submittals and sketches are true and accurate and that I have been authorized by the owner(s) to conduct these necessary field investigations and submit this request.

Part A prepared by: [Signature] License # 4057 Part B prepared by: [Signature] License # 4057

DO NOT WRITE IN THIS SPACE

Witnessed Soil Evaluation Decision: Concur Inconclusive Disclaim

Unwitnessed Soil Evaluations Decision: Accept Inconclusive Disclaim

Wet Season Determination required Additional Field Review Required

Explanation: _____

Signature Authorized Agent: [Signature] Date: 8/23/23

Part B

Site Evaluation - to be completed by Soil Evaluator or Class II or III Designer

Please use the area below to locate:

1. Test holes and bedrock test holes,
2. Approximate direction of due north,
3. Offsets from all test holes to fixed points such as street, utility pole, or other permanent, marked object.*
*OFFSETS MUST BE SHOWN

Key:

- Approximate location of test holes
- Approximate location of bedrock test holes
- Estimated gradient and direction of slope
- Approximate direction of due north

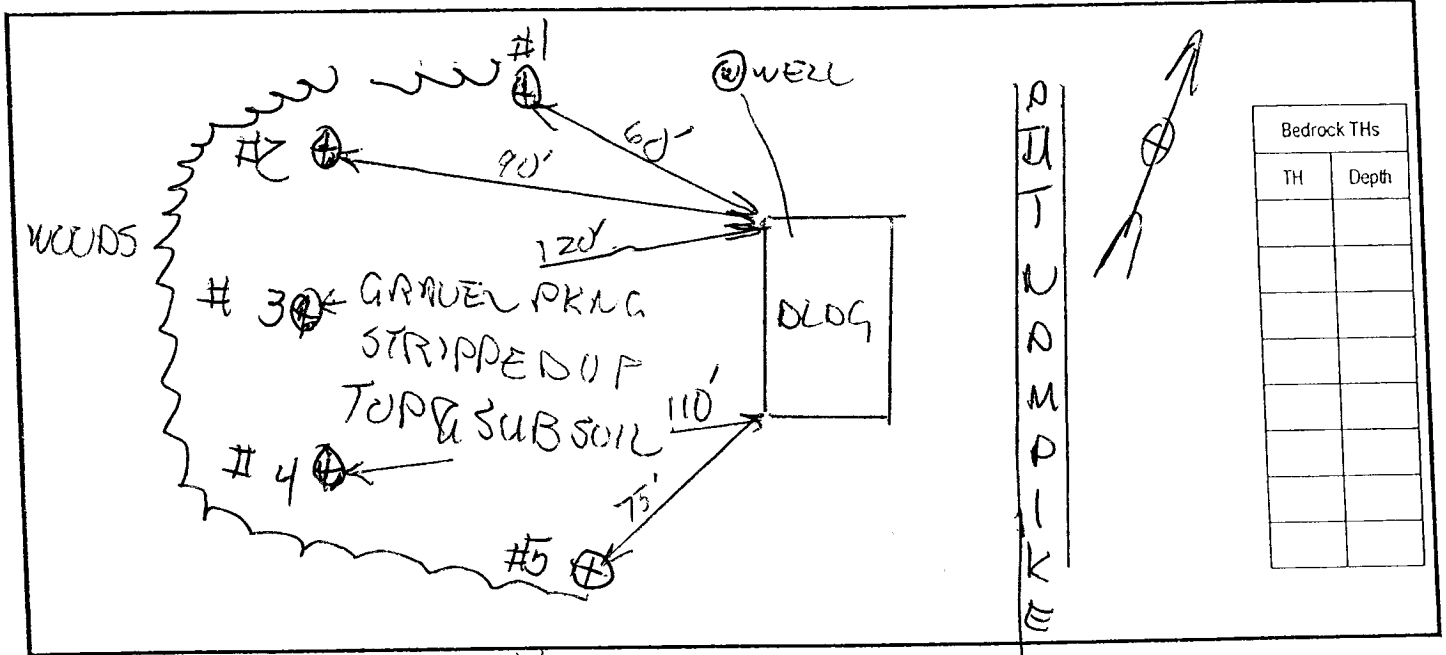

1. Relief and Slope: FLAT 0-2%
2. Presence of any watercourse, wetlands or surface water bodies, within 200 feet of test holes? If yes, locate on above sketch. NO YES
3. Restrictive Layer or Bedrock within 4' below original ground within 25 feet of test hole? Provide all test hole locations & depths above. NO YES
4. Presence of existing or proposed private drinking water wells within 200 feet of test holes? If yes, locate on above sketch. NO YES
5. Public drinking water wells within 500 feet of test holes? If yes, locate on above sketch. NO YES
6. Is site within the watershed of a public drinking water reservoir or other critical area defined in Rule 38? NO YES
7. Has soil been excavated from or fill deposited on site? If yes, locate on above sketch. NO YES
8. Site's potential for flooding or ponding: NONE SLIGHT MODERATE SEVERE
9. Landscape position: BACK SLOPE
10. Vegetation: NONE
11. Indicate approximate location of property lines and roadways.
12. Additional comments, site constraints or additional information regarding site: SDK GROUP 1; 150' TOWER

Certification

The undersigned hereby certifies that all information on this application and accompanying forms, submittals and sketches are true and accurate and that I have been authorized by the owner(s) to conduct these necessary field investigations and submit this request.

Part A prepared by: [Signature] License # _____ Part B prepared by: [Signature] License # _____

DO NOT WRITE IN THIS SPACE

Witnessed Soil Evaluation Decision: Concur Inconclusive Disclaim

Unwitnessed Soil Evaluations Decision: Accept Inconclusive Disclaim

Wet Season Determination required Additional Field Review Required

Explanation: _____

[Signature] Signature Authorized Agent Date: 8/23/23